

Thank you for purchasing "SUPER REEF OCTOPUS" protein skimmer. For optimum performance and safety, please read this instruction manual carefully and keep it handy for future reference.

RO-RPS-2000Ext External skimmer

Function of protein skimmer:

Protein skimmer are applied to most saltwater aquarium to remove certain organic compounds, including proteins and amino acids, by using the polarity of the protein itself, from the water to stop most of them decomposing into nitrogenous waste. Because of the intrinsic charge, water-borne proteins are attracted to the air-water interface. Protein skimmers works by injecting numerous tiny bubbles into the water chamber, which present an enormous air-water interface for the protein molecules to cling to. The more tiny bubbles reside in the chamber, the more proteins it absorbs.

Protein skimming is the only way of physical filtration that get rid of the organic compounds before its decomposition, lightening the load on the biological filter and improving the water's redox potential.

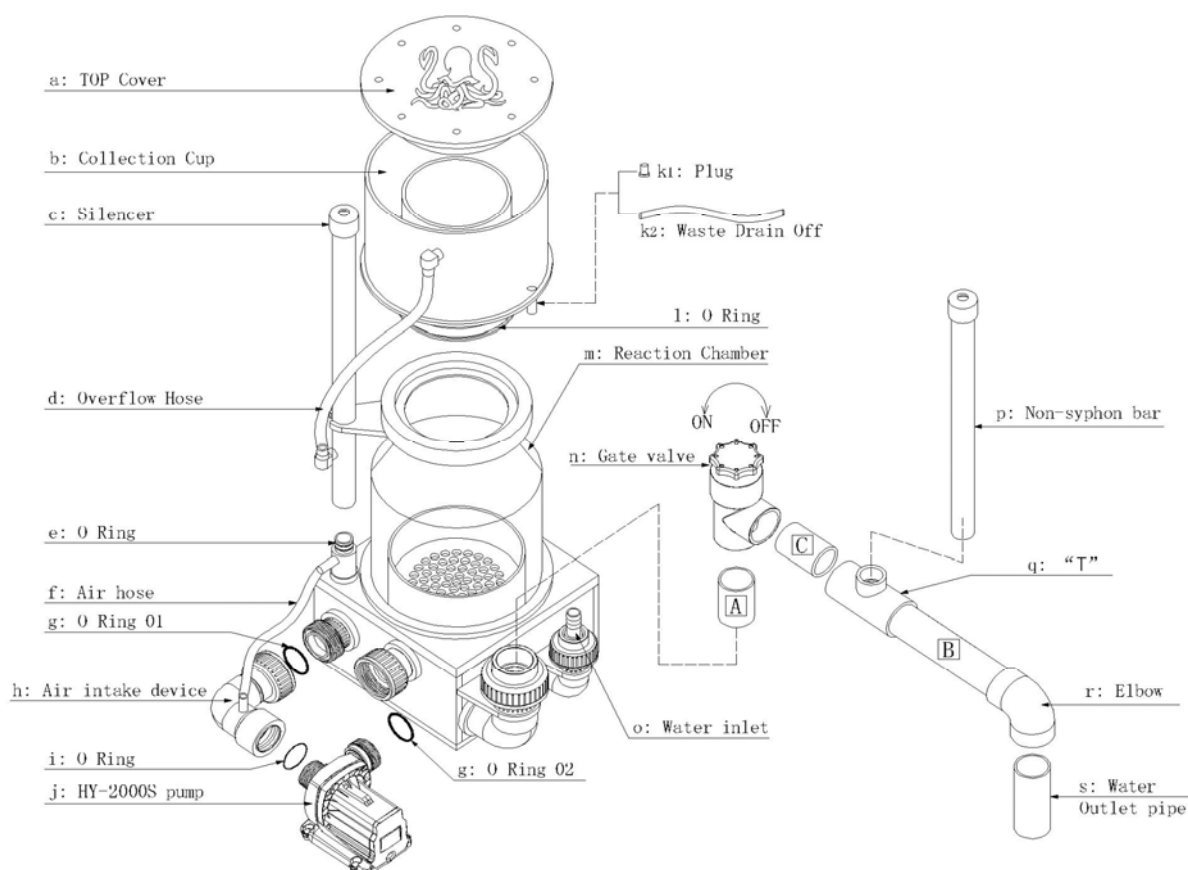

Parts check list

a. Top cover	f. Air hose	k1. Plug	o. Water inlet
b. Collection cup	g. Oring 01	k2. Waste drain off hose	p. Non syphon bar
c. Silencer	h. Air intake device	l. O ring	q: "T"
d. Overflow hose	i. O ring	m. Reaction Chamber	r. Elbow
e. O ring	j. BB pump	n. Gate valve	s. water outlet pipe

Installation

1. Remove the skimmer body and all the assembly parts from the package by the check list.
2. Screw the union with the air intake device to the pump and fix the pump to the chamber according to the illustration.
3. Setting up the water outlet pipe system, make sure the pipe A ,B,C & Non-syphon bar (p) are in place by the illustration.
4. Connect the air hose from the air intake to the silencer, then the overflow hose from the silencer to the collection cup .
5. Inset the collection cup with top cover onto the skimmer tower. Make sure the O-ring is in place. Find a soft tubing to connect to draff off. Or use the plastic plug.
6. Put the skimmer in place, it is external use only. Connect the inlet “o” with supply water. Power on, Turning the gate valve to adjust the water level for skimming.

Maintenance

Collection Cup: It should be taken away to clean up at least once a week, depend on the organic load. Cleaning will enhance the extraction substantially.

Reaction Chamber: Internal clean up every 6 months for once.

Safety Tips

1. Do not allow the skimmer pump to run dry.
2. Do not touch the plug with wet hands
3. Do not clean the skimmer with any chemicals that alcohol or ammonia, or it will make the animals in the tank in danger.

Warranty

Reef Octopus skimmers have the 1 year warranty on craftsmanship, 3 year on the bubble blaster pump.

We are responsible for the products as long as it's been installed and used properly. Consumable spare parts are not applicable to the warranty.

If Reef Octopus products in hand does not appear to be working correctly or be defective, pls contact the local dealer.

Before calling your dealer pls ensure you have read the manual.

Or you can contact us at www.reefoctopus.com

We hereby reserve the rights to modify and adjust the specification or designs of our products without a prior notification. Thank you!